



The

# Main Line

October 2020



National Model Railroad Association

Mid-Continent Region

The Monthly publication of the **Western Kansas Division**



On the cover:

With the COVID restrictions it is hard to travel to layouts and train shows, so we will look back in the photo archive and take a layout tour of Duane Riley's HO-scale home layout.

Also in this issue:

**The Real Deal...**Page 3

**New N-scale well cars from JTC...**Page 6

**Lights, Camera, Action!...**Page 10

**Layout Look Back**, a tour of Duane Riley's HO-scale layout...Page 15



See Dave & Deb at the store in Deshler, or check-out their website by clicking on the link:

[Spring creek Model Trains](http://SpringcreekModelTrains.com)



## Editor's Musings

Since the Kansas government has decided to extend the mask requirements another few weeks, it continues to be a major obstacle to travel as people are concerned about their health. "It is what it is" ... so while browsing through picture files on my computer, I have decided to start taking a look back at the many magnificent layout I had the pleasure in visiting over the past few years.

For those of us who are retired, now might be a great time to start checking under the layout, the closet, the storage containers and find all those kits you forgot you had. One advantage of having to pack-up and move our entire home was finding boxes of various kits I had long forgotten I had purchased. So now, I at least have them all in a single storage container, and I know where they are.

In the last few weeks I have tried to keep busy by doing a "strip and clean" on my operating session locomotives and making a few new videos for the Division YouTube channel (more on this later in this issue).



**When  
you buy  
your 1st**

House plant

Train



**When  
you buy  
your  
237th**

House plant

Train



# The Real Deal

(Todd Skaggs Photo)



Todd Skaggs recently took a vacation trip to Colorado, found this fallen flag boxcar just east of Pueblo.



Dipping into the archive, this set of BNSF power was my last rail fan excursion in Garden City, KS. Six locos are tied down on the stock track, roughly 26,400 horsepower awaiting their next call to duty.



# The Real Deal



Back in May of 2019, Garden City had a visitor, Norfolk Southern 9576







Be sure to check-out the YouTube channel for the **Western Kansas Division**, then please subscribe and click on the bell for notifications. You can go there now by clicking on the link below:

[Western Kansas Division - YouTube](#)





# NEW JTC Well Cars

## N-scale

Earlier this year, Jacksonville Terminal Company, LLC (JTC) released their new well cars in N-scale. Since I pre-ordered them, I was able to get them early. As soon as they came out of the boxes, I fell in love with them. The detailing is excellent and since they are cast from metal, they are not as heavy as the much older Walthers metal cars, but heavier than recent plastic versions.



The etched metal detailing is some of the best I've seen in N-scale. I took the liberty of painting the couplers and wheel sides Rust Brown (they come black), but otherwise these are right out-of-the-box.

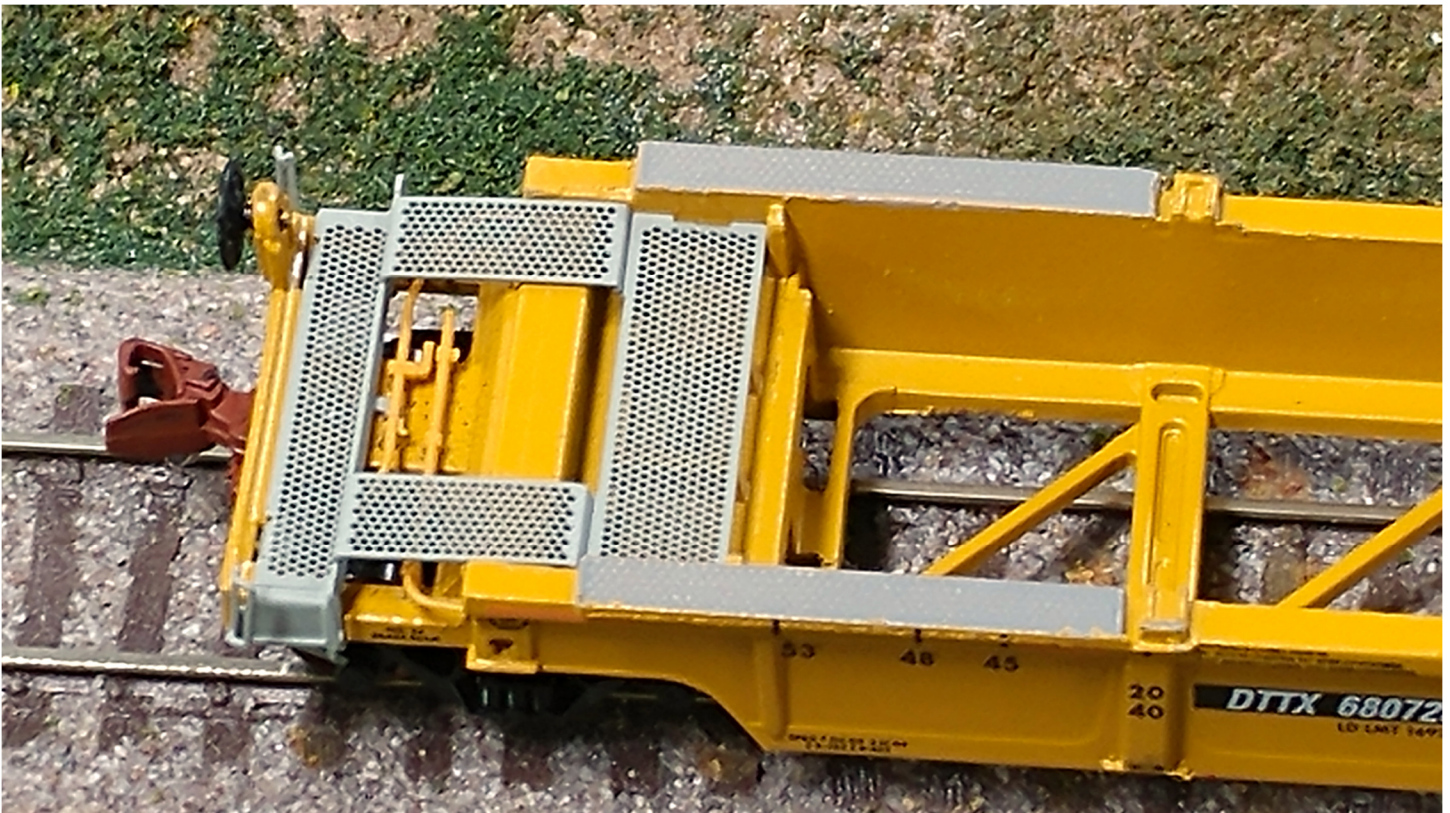



# NEW JTC Well Cars



The wheel sets are plastic and roll quite freely however I am switching all rolling stock to metal wheels which is a minor inconvenience and keeps the cost reasonable. Just add your favorite containers, and you have an eye-catching intermodal train. Well done JTC!

Check-out all their N-scale products on their website: [Jacksonville Terminal Company, LLC](http://www.jacksonvilleterminalcompany.com)





# Hold N-scale engine away from you like this Daniel son

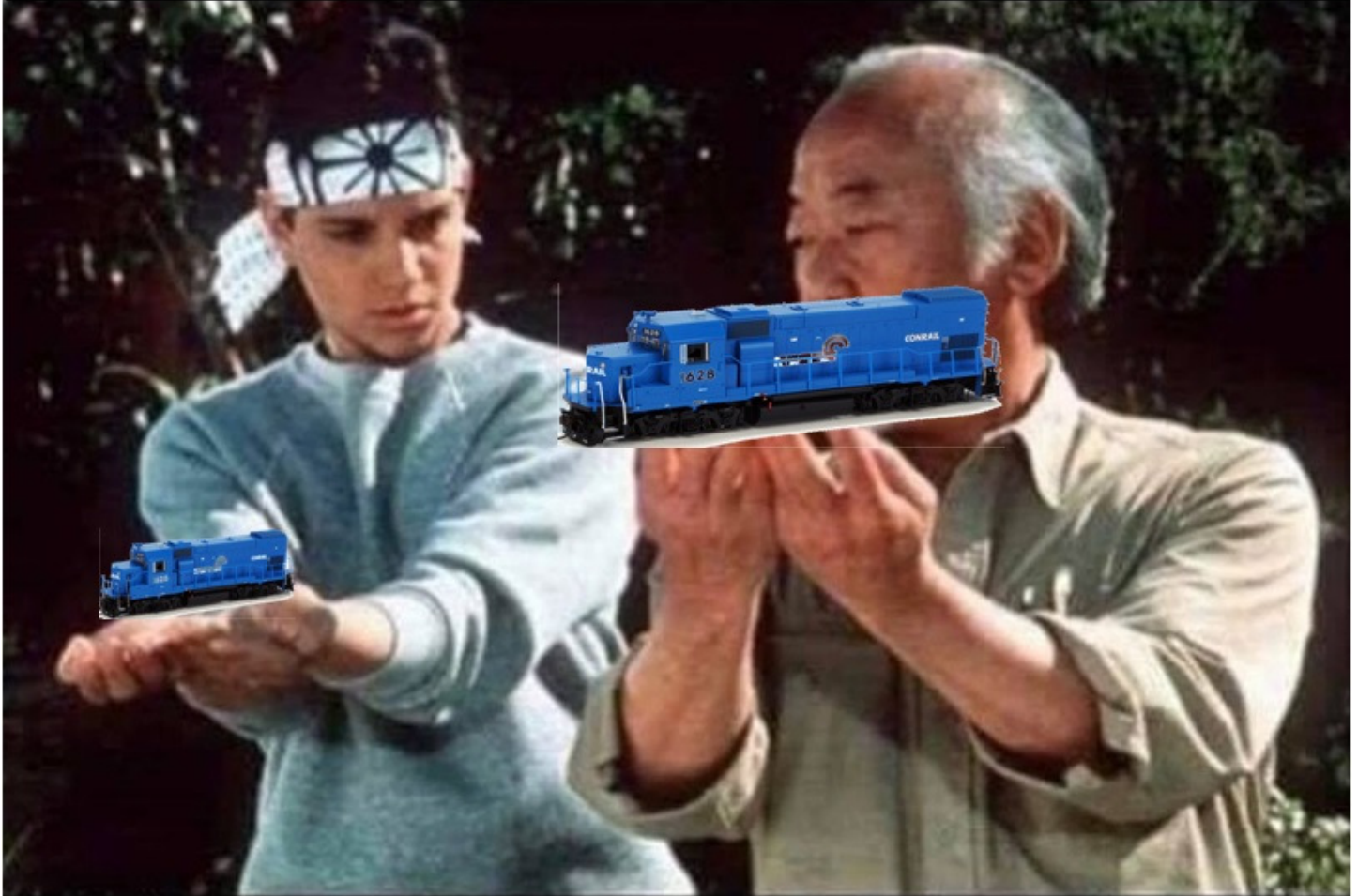

## Make N-Scale engine look like O-Scale... impress internet friends you will!



You can follow the antics of the **Western Kansas Division**, NMRA on Face Book

Click on the link: [Western Kansas Division, NMRA](#)



The brand new 2021 [Missouri Pacific Historical Society](#) calendar is out, I just got mine, be sure to get yours...



You can check out their web site here:

[Missouri Pacific Historical Society](#)

Don't forget their Face Book page as well: [Missouri Pacific Historical Society - Face book](#)

If you're not a MoPac fan, check out the Historical Society of your favorite Railroad...



# Lights, Camera, Action!



Recently I have been attempting to make some different, more interesting train videos and last month I showed how I was producing them.

Since then, I have purchased a second Bell & Howell TAC Camera, both are pictured at left in the bottom of the photo. Since they are identical, I labeled them "1" and "2" (I know, how original) so I can tell them apart.

Interesting little cameras, they have an internal battery, 16-gig memory card and a large focus area. The only short coming I discovered, they will not focus on something closer than about 4-inches to the lens.

As you may recall from last month, I used an old flat car as a rolling platform to raise the camera height to that of a locomotive cab view and is pushed by the locomotive. This served well in the first series of operations videos.



My first thought to add variety to the videos was to edit external shots in with the cab view shots. My first idea was to use my cell phone for the external shots and it does video very well, but I remembered that the TAC Cameras use an avi-format and my cell phone does not, so editing two different formatted videos together seemed rather daunting.

After contemplating the possibilities for a while, I remembered I had recently purchased a second TAC Camera as a back-up in case unit 1 expired suddenly. Using two different cameras that used the same avi-format has been proven to be the answer.



# Lights, Camera, Action!



(Above) This photo shows the relative position of the two cameras while shooting a scene. Camera 1 usually travels on the flat car, while camera 2 usually takes the “rail fan” view.

If I shot the video exactly like this, you would see the camera car in front of the train, so For the sake of the videos I run each sequence twice, once without the camera car for the “rail fan” views, then with the camera car to capture the cab views.

Each camera records the video into separate video files of about 4-minutes each before beginning a new file. Recording the raw video usually takes about 20-minutes, so each camera will have around eight video files. This is perfect for my needs, but the memory cards are limited, so if you should go too long, it re-records over the first file and so on.

The next step is to download the video files from the cameras to my desktop, and the cameras come with the correct USB cable.

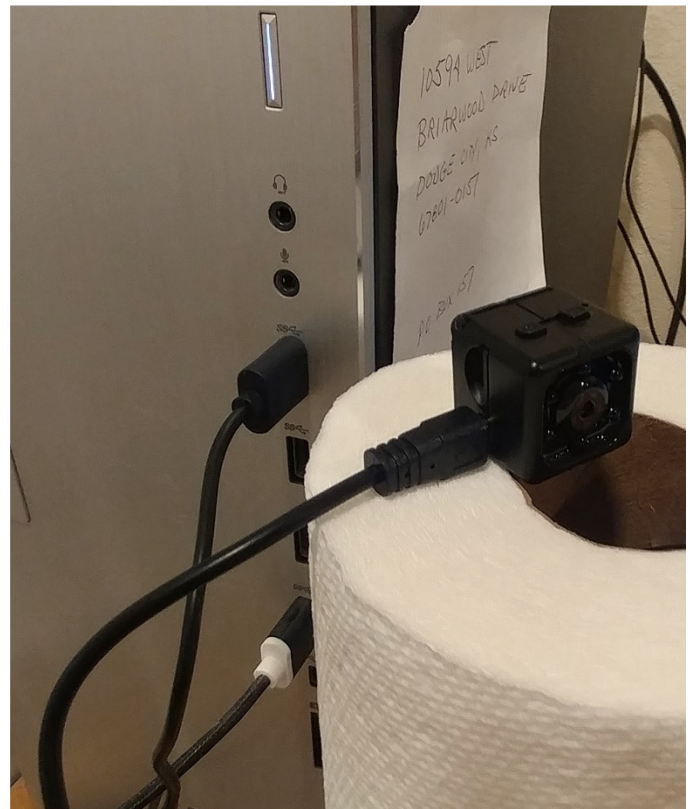



# Lights, Camera, Action!

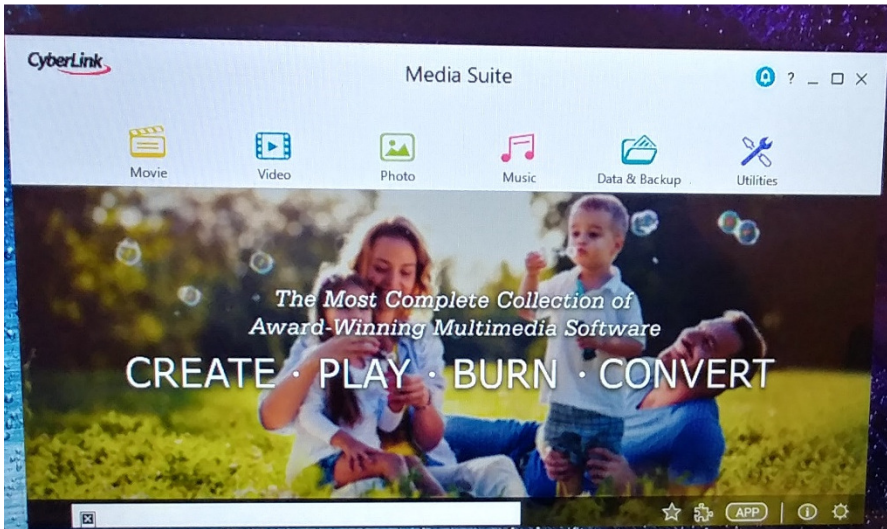

(Left) I use Cyberlink Media Suite to download the video files and edit them together. Once you click on the short cut, this is the opening screen that allows you to select which function you wish to use, in this case “video”.

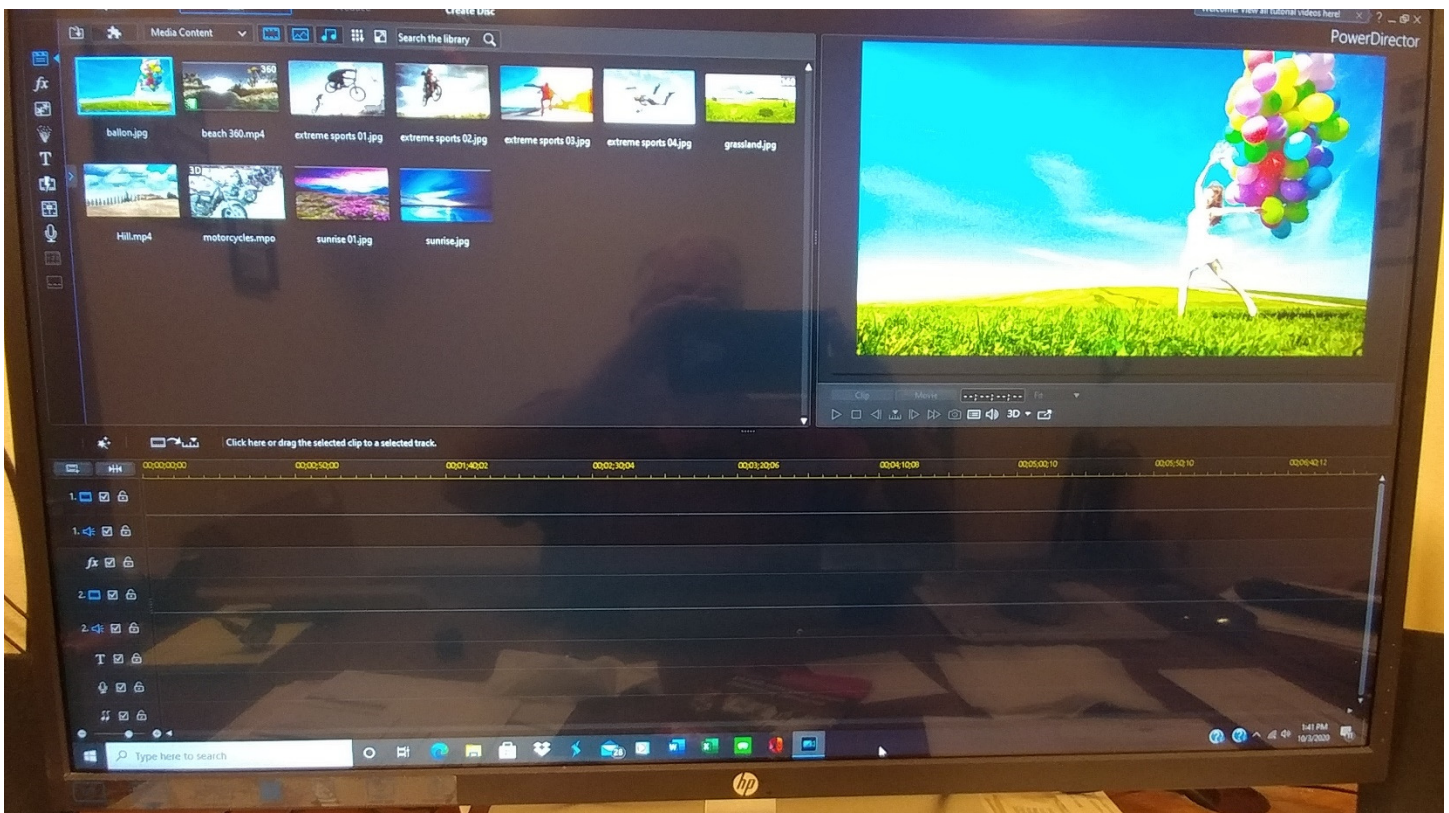

(Above) This is the “timeline” editing screen I prefer; your incoming video files are displayed in the upper left section. The file you are editing is placed just below the yellow markers (the top half video, the bottom half audio) while the display in the upper right (girl with balloons) is what you are currently editing and changes as you go.



Operating Session 1-R, Train 1, Movement 2 (Part 1)

<https://www.youtube.com/watch?v=n0HVtBxaaLM&t=3s>

Operating Session 1-R, Train 1, Movement 2 (Part 2)

<https://www.youtube.com/watch?v=cUdvtbLckqk&t=1s>





# If Model Railway Fans Designed Houses....

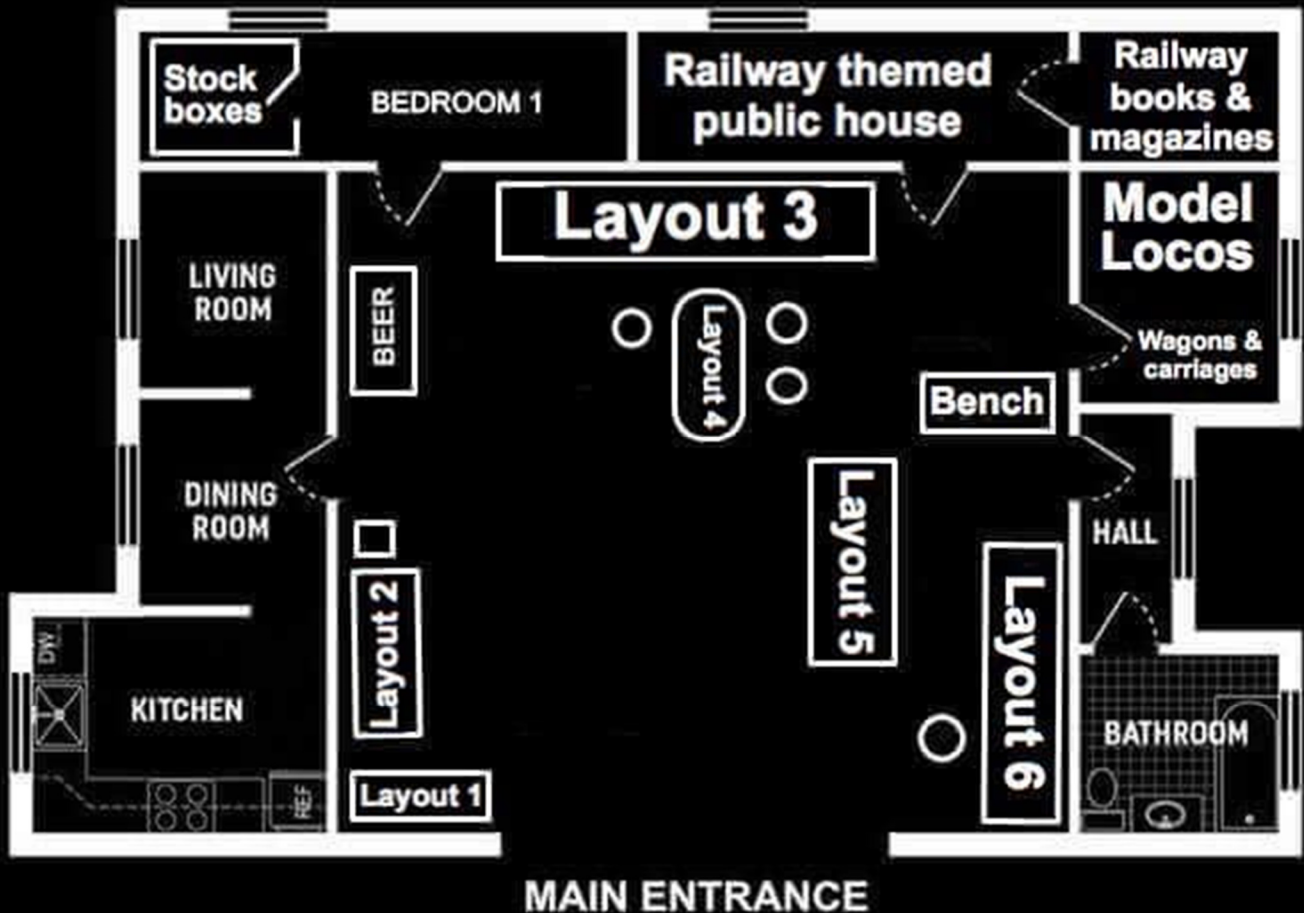

You can register for free and receive Model Railroad Hobbyist Magazine each month in your e-mail box  
Just click on the link below:

[Model Railroad Hobbyist Magazine](#)

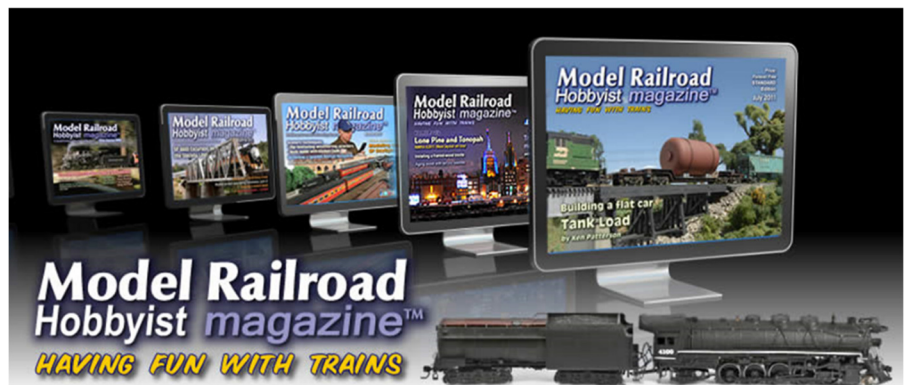



Dispatcher to OpSIG Publication No. 2, you're ...

# Ready to Roll!

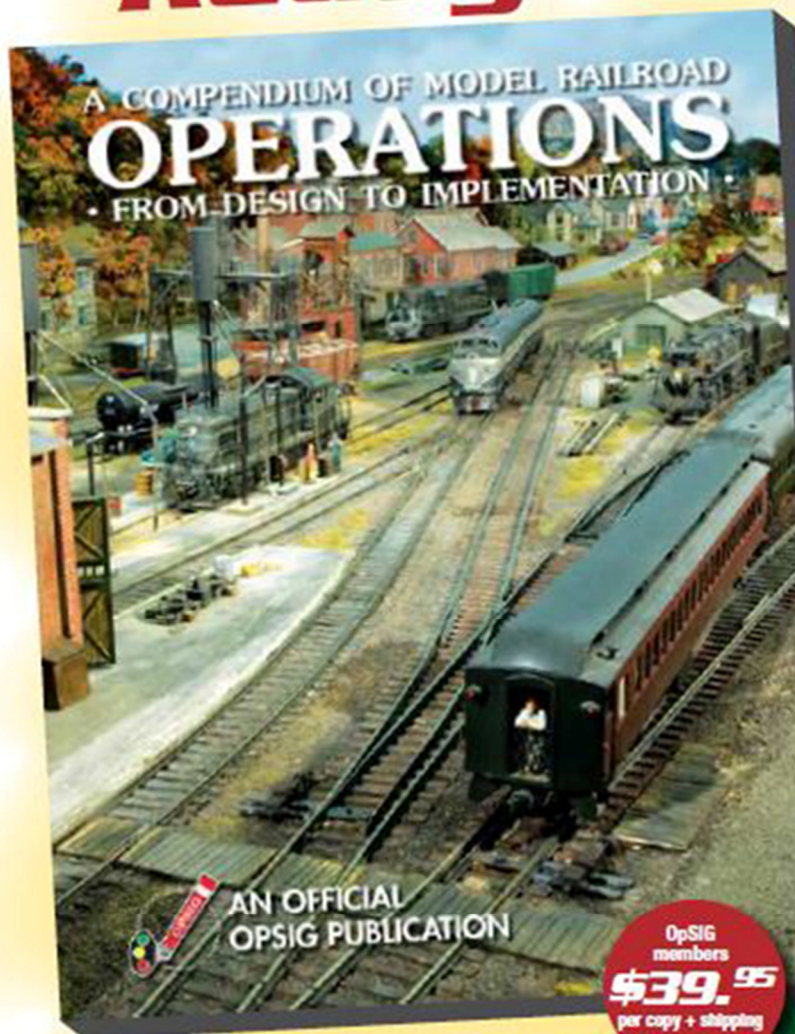

All model railroaders, whether expert or beginner, will find a wealth of useful information in the OpSIG's second publication, **A Compendium of Model Railroad Operations - From Design to Implementation**. A complete guide to all things operations, our latest offering covers every aspect of prototype operations and how to apply them to your model railroad—from design and staffing to yards and paperwork, from communications and signals to dispatching and car forwarding—in 310 full-color pages. Written by ten of your fellow modelers and professionals, **The Compendium** contains more than 350 photos, 120 illustrations, and countless tips, pointers, suggestions, and prototype information to help guide you on your journey. A must for any modeler interested in prototype operations, add it to your library today!

OpSIG  
members  
**\$39.95**  
per copy + shipping

Non-  
members  
**\$49.95**  
per copy + shipping

Shipping: US (\$8)  
Canada/Mexico (\$21)  
Overseas (\$28)

For shipping rates on multiple books,  
as well as better international shipping,  
please contact Steve Benezra.

**To Order:** Please mail a check or money order, payable to OpSIG, with number of copies and your mailing address, phone number, and e-mail to:

Steve Benezra  
2737 Thistle Trail  
Hillsborough, NC 27278-9302  
Opsig.editor@gmail.com

For Paypal orders, please add \$1 to the cost of the book and send to [OPERSIG@yahoo.com](mailto:OPERSIG@yahoo.com). Provide your mailing address and telephone number in the subject box.

The OpSIG is a 501(c)3 non-profit corporation. For information on how to join the OpSIG, please visit [www.opsig.org](http://www.opsig.org).



# Layout Look Back



It's 2018 and the Southwest Kansas Railroad Society held a meeting at Duane Riley's home in Garden City, Kansas.

When I get the opportunity, I tote the cameras and document the layout as best I can in the time allowed. Now with the COVID restrictions making travel risky at best we're dipping into the archives to view some truly impressive layouts.

Duane's HO-scale layout encompasses about half of the basement of his home and features multiple levels. One change from 2018, is at the entrance door where you formerly had to crawl under the layout to gain entry, Duane has now installed a lift bridge.



The plus of the bridge is obvious, but the downside was it required the removal of the entrance to the storage yard on the lowest deck. The silver lining comes with the removal of all the storage tracks (quite a bit) that was cleaned And sent to his Grandson for his new layout.



# Layout Look Back



When you have a large layout, you can build some impressively large industries, such as this paper mill (above).

(Left) Duane's layout features several grain handling facilities.



(Right) A combination station and transfer point with a load of tractors going to the local dealership.





# Layout Look Back

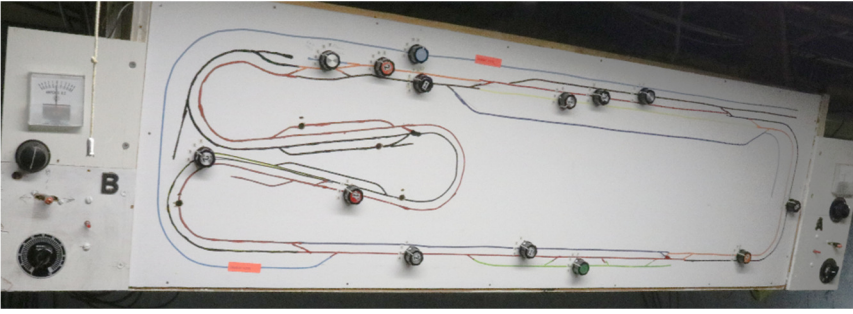

(Above & Right) Duane spent a lot of time wiring the layout for DC control and put a lot of effort into the control panels as well as making home-made walk around throttles so he has never felt the urge to upgrade to DCC.

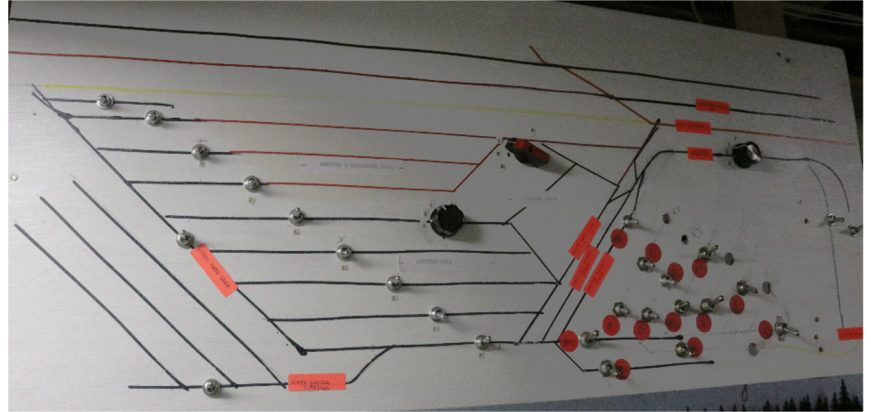

(Below) A larger grain facility in the era of transporting grain in boxcars.





# Layout Look Back



The main feature of the layout is a huge yard that encompasses a diesel engine service facility on one end (Left) to a steam facility on the other. A few years back, Duane decided to back-date his “modern” layout to his favorite “transition” era. A lot of very fine diesels went to new homes from sales tables at train shows, while a lot of new steam locos began to appear.



Duane never lets details get in the way. He has a steam loco that free wheels with the actual motive power coming from the tender... whatever works.





# Layout Look Back



A big Thank You to Duane Riley of Garden City, Kansas for allowing this look at his home layout. Until we can get back to traveling again, we can appreciate the layout we have seen in the past.









Official Journal of the Operations Special Interest Group

# THE Dispatcher's Office

## Warner Swarner's Bears paw Southern Garden Operations

Vol. XXVI No. 4 / October 2020 \$8.00

The Oregon native builds  
a G-Gauge Operation  
surrounding the outside  
of his home

Being a New Hire and Learning  
About Railroading

Using JMRI Operations

TT&TO on Tehachapi

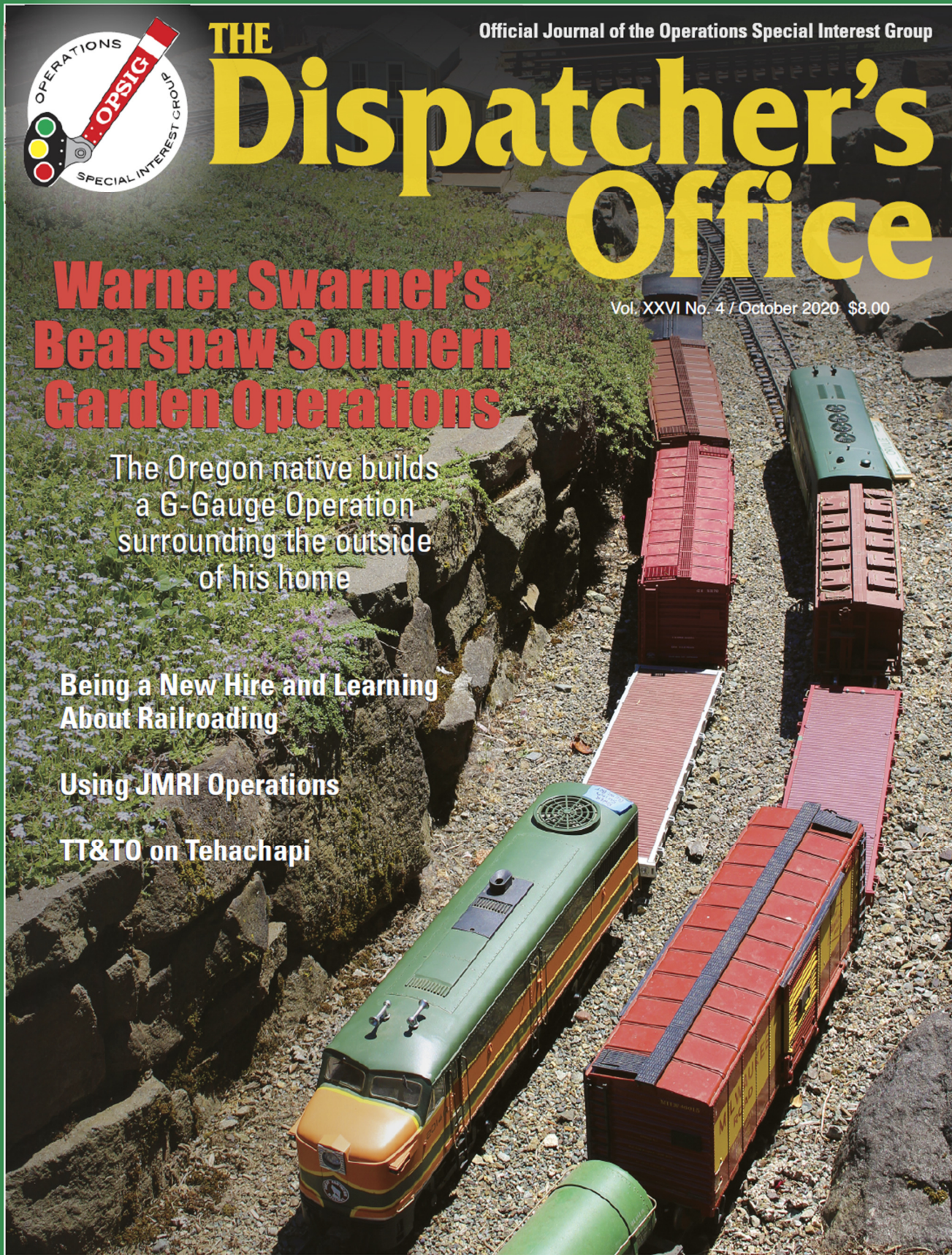





Visit the Website of OPSIG here:

<https://www.opsig.org/>

Visit the Face Book OPSIG page here:

<https://www.facebook.com/OperationsSIG>

Be sure to visit and contribute to the Face Book page  
Of the Mid-Continent Region, NMRA:

<https://www.facebook.com/groups/1851848998468077>



The Mid-Continent Region has a website that features  
information about the Region, conventions in the Region, list of  
Divisions and contact info, links to Region and Division  
newsletters and more...

<http://mcor-nmra.org/>





On the back cover:

A final look at Duane Riley's HO-scale home layout with a view showing the immense length of the layout and the multi-deck design. Thanks to Duane for his kind permission for this look back.

## The **Main Line**

Publisher & Editor: Robert A. Simmons

The newsletter of the Western Kansas Division is published monthly for no charge by Robert A. Simmons, Division Superintendent / Director

Copyright 2020, by Robert A. Simmons, all rights reserved

If you have a change of e-mail address, or no longer wish to receive the newsletter, please contact Robert Simmons

[Trainman55@hotmail.com](mailto:Trainman55@hotmail.com) or P.O. Box 157 – Dodge City, KS. 67801 or call (620) 521-3591

Please send all inquiries, ideas, or submissions to: [trainman55@hotmail.com](mailto:trainman55@hotmail.com)